

High Efficiency "HE" Type Scrap Magnet.

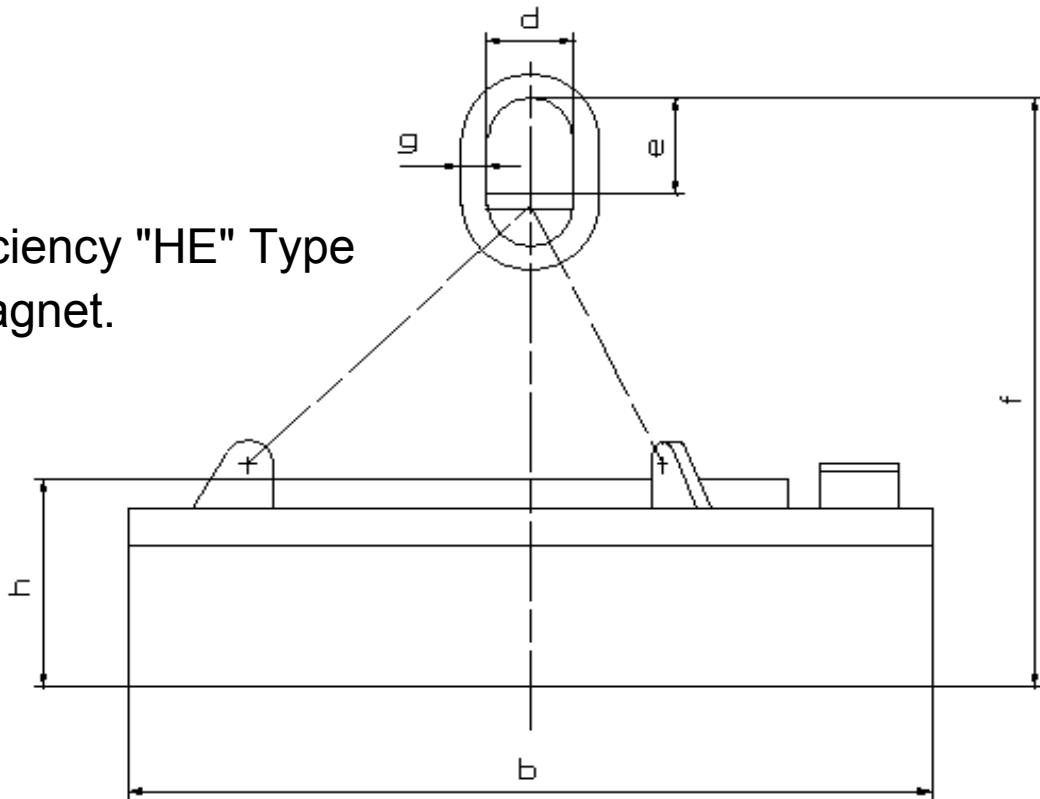

MAGNET TYPE	RM	1350/0	1550/0	1750/0	1950/0	2150/0	2350/0	2550/0
Power consumption [W]		9'590	10'020	12'410	15'240	17'670	19'100	23'550
Voltage [V]		220	220	220	220	220	220	220
Current [A]		43.6	45.5	56.4	69.3	80.3	86.8	107.1
Dead weight [kg]		2'970	4'160	5'280	7'130	9'120	10'890	13'480
DIMENSIONS								
b [mm]		1'350	1'550	1'750	1'950	2'150	2'350	2'550
f [mm] ~		900	900	900	900	1100	1100	1100
e [mm]		130	130	220	220	220	220	220
d [mm]		110	110	190	190	190	190	190
g [mm]		32	32	50	50	50	50	50
h [mm]		446	466	476	496	516	526	546
LOAD CAPACITY [kg]								
Tear-off force		39'100	54'900	62'800	85'000	107'600	118'600	145'200
Blocks and slabs		19'600	27'500	31'400	42'500	53'800	59'300	72'600
Pig iron		1'500	2'110	2'420	3'270	4'140	4'560	5'580
Cast steel fragment		1'400	1'960	2'240	3'040	3'840	4'240	5'190
Main scrap		1'300	1'830	2'090	2'830	3'590	3'950	4'840
Metal chips		650	920	1'050	1'420	1'790	1'980	2'420